

SSMB, SCMS, SSMC SPECIFICATIONS



ELECTRICAL

Impedance	50 Ω nominal	
Frequency Range	DC-12.4 GHz.	
Voltage Rating	250 VRMS @ sea level; 60 VRMS @ 70,000 ft.	
Insulation Resistance	1,000 megohms minimum	
Contact Resistance:		
Center contact	Initial: 4.0 milliohms maximum; after environmental test conditions: 6.0 milliohms maximum.	
Outer contact	Initial: 1.0 milliohms maximum; after environmental test conditions: 1.5 milliohms maximum.	
Cable braid to body	Initial: 1.0 milliohms maximum; after environmental test conditions: N/A.	
Corona Level	125 V @ 70,000 ft.	
RF highpot	400 VRMS @ 5 MHz.	
RF Leakage	-50 dB min @ 2-3 GHz.	
Insertion loss	.30 dB max @ 1.5 Ghz.	
VSWR: SSMC:		
Cable:	Straight Connector:	Right angle Connector:
RG178	1.20+ (.20 x F[GHz])	1.20+ (.30 x F[GHz])
RG316	1.25+ (.20 x F[GHz])	1.25+ (.30 x F[GHz])
.085 Semi-rigid	1.20+ (.15 x F[GHz])	1.20+ (.30 x F[GHz])
VSWR: SSMB & SCMS:		
Cable:	Straight Connector:	Right angle Connector:
RG178	1.25+ (.20 x F[GHz])	1.25+ (.30 x F[GHz])
RG316	1.30+ (.20 x F[GHz])	1.30+ (.30 x F[GHz])
.085 Semi-rigid	1.25+ (.15 x F[GHz])	1.25+ (.25 x F[GHz])

MATERIALS

Plug spring fingers, center contacts	SSMB & SCMS: Beryllium copper per ASTM-B-196, Condition HT; SSMC: N/A
Jack mating ends, center contacts	SSMC: Beryllium copper per ASTM-B 196, Condition HT. SSMB & SCMS: N/A
Crimp sleeves	Seamless copper tube per ASTM-B-75, type C12000, temper: light anneal 050
Other metal parts	Brass per ASTM-B-16, Alloy 360, 1/2 hard
Insulators	Teflon (TFE) per ASTM-D-1710

FINISH

Center contacts	Gold plated per MIL-PRF-39012, IAW MIL-G-45204
Other metal parts	Gold plated to meet current MIL-PRF-39012 corrosion requirements

The closed entry female contact shown is not always in inventory for all part numbers. Consult factory for current availability.

ENVIRONMENTAL (MIL-STD-202)

Temperature range	-65°C to +165°C
Corrosion	Method 101, condition B, 5% salt solution.
Mechanical shock (Method 213)	SSMB, SSMC: Condition B, 75G @ 6ms @ 1/2 sine SCMS: N/A
Vibration (Method 204)	SSMB: Condition B (15G); SCMS: Condition A (10G); SSMC: Condition D (20G)

MECHANICAL

Force to engage	SSMB: Initial, 6 pounds max engagement, 2 pounds min disengagement. After 500 matings, 6 pounds max engagement, 1 pound min disengagement. SCMS: Initial, 3 pounds max engagement, 5 pounds min disengagement. SSMC: 16 inch-ounces torque max.
Mating torque	SSMB & SCMS: N/A; SSMC: 28-32 inch-ounces.
Coupling nut pulloff resistance	25 pounds min.
Contact retention	2 pounds min axial force
Durability	500 mating cycles

RECOMMENDED MOUNTING HOLE SIZE

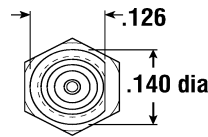

Due to their small size and tight tolerances, plating other than gold is not recommended. Consult factory for information.

CABLE GROUP CODES

23	RG178, 196,404	26	RG178DS, Microdot 250-3908
24	24A RG174, 179, 187, 188, 316, LMR100, LMR100A	29	RG188DS, 174DS, 316DS
	24B Not applicable for these connector series	31	.085 Semi-rigid or ULTRA-FLEX (RG405)
		32	.047 Semi-rigid
		42B	.056 Semi-rigid

SSMB/SCMS* INTERFACE DIMENSIONS

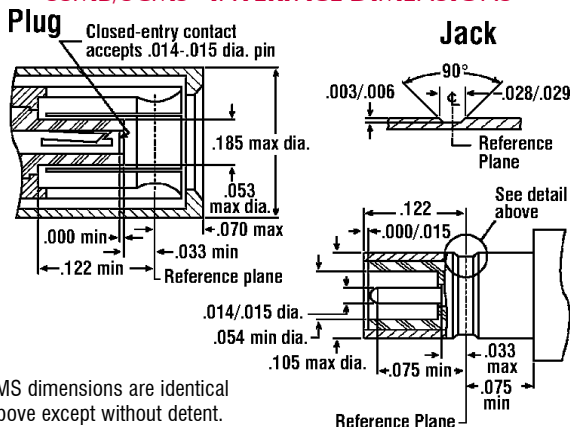

* SCMS dimensions are identical to above except without detent.

SSMC INTERFACE DIMENSIONS

